

# Installation Guide

Installation Kit: 911-6109-10



This installation guide covers various makes and models of equipment. See pages 2 & 3 for supported models.

## Supported Models

AGCO	Case IH		Challenger	
DT-160	FLX 3310	Patriot 3230	MT455B	MT635
DT-180	FLX 3510	Patriot 3240	MT455D	MT635B
DT-180A	Magnum 180	Patriot 3320	MT455E	MT645
DT-200	Magnum 190	Patriot 3330	MT465	MT645B
DT-200A	Magnum 200	Patriot 3340	MT465B	MT645C
DT-205B	Magnum 210	Patriot 4420	MT465D	MT645D
DT-220A	Magnum 215	Patriot 4430	MT465E	MT645E
DT-225B	Magnum 220	Patriot 4440	MT475B	MT655
DT-240A	Magnum 225	SPX 4410	MT475D	MT655B
DT-250B	Magnum 235	Steiger 330	MT475E	MT655C
DT-275B	Magnum 240	Steiger 335	MT485D	MT655D
RT-95	Magnum 245	Steiger 350	MT485E	MT655E
RT-100	Magnum 250	Steiger 370	MT495D	MT665
RT-100A	Magnum 260	Steiger 380	MT495E	MT665B
RT-120	Magnum 275	Steiger 385	MT515D	MT665C
RT-120A	Magnum 280	Steiger 400	MT515E	MT665D
RT-135	Magnum 290	Steiger 420	MT525B	MT665E
RT-140A	Magnum 305	Steiger 430	MT525D	MT675C
RT-150	Magnum 310	Steiger 435	MT525E	MT675D
RT-155A	Magnum 315	Steiger 450	MT535	MT675E
RT-165A	Magnum 335	Steiger 470	MT535B	MT685C
RT-180A	Magnum 340	Steiger 480	MT535D	MT685D
	Magnum 370	Steiger 485	MT535E	MT685E
	Magnum 380	Steiger 500	MT545	
	MX100	Steiger 530	MT545B	
<b>McCormick</b>	MX100C	Steiger 535	MT545D	
	MX110	Steiger 540	MT545E	
MC100	MX120	Steiger 550	MT555B	
MC105	MX135	Steiger 580	MT555D	
MC115	MX150	Steiger 600	MT555E	
MC120	MX170	Steiger 620	MT565	
MC130	MX180	STX275	MT565B	
MC135	MX200	STX280	MT565D	
MC95	MX210	STX325	MT565E	
MTX110	MX210	STX330	MT565E	
MTX120	MX215	STX335	MT575B	
MTX125	MX220	STX375	MT575D	
MTX135	MX230	STX380	MT575E	
MTX140	MX230	STX385	MT585B	
MTX145	MX240	STX425	MT585D	
MTX150	MX245	STX430	MT585E	
MTX155	MX255	STX435	MT595B	
MTX165	MX255	STX440	MT595D	
MTX175	MX270	STX450		
MTX185	MX275	STX480		
MTX200	MX285	STX485		
TTX190	MX285	STX500		
TTX210	MX305	STX530		
TTX230	MX335			
ZTX230				
ZTX260		Includes Quadtracs		
ZTX280				

## Supported Models

---

Claas		New Holland		Massey Ferguson	
Axion 810 <sup>+</sup>		T8.275	T9020	5465	7465 7724S
Axion 820 <sup>+</sup>		T8.300	T9030	5470	7475 7726
Axion 830 <sup>+</sup>		T8.320	T9040	5475	7480 7726S
Axion 840 <sup>+</sup>		T8.330	T9050	5480	7485 8220
Axion 850 <sup>+</sup>		T8.350	T9060	5609	7490 8240
Axion 860 <sup>+</sup>		T8.360	TG210	5610	7495 8245
Axion 870 <sup>+</sup>		T8.380	TG215	5611	7497 8250
Axion 880 <sup>+</sup>		T8.390	TG230	5612	7499 8260
Axion 920		T8.410	TG245	5613	7614 8270
Axion 930		T8.420	TG255	5710	7615 8280
Axion 940		T8.435	TG275	5711	7616 8450
Axion 950	*2014 & newer	T8010	TG285	5711SL	7618 8460
Axion 960	*2020 & newer	T8020	TG305	5712SL	7619 8470
Lexion 6800		T8030	TJ275	5713SL	7620 8480
Lexion 6900		T8040	TJ280	6465	7622 8650
Lexion 7400		T8050	TJ325	6475	7624 8660
Lexion 7500		T9.390	TJ330	6480	7626 8670
Lexion 8600		T9.435	TJ375	6485	7714 8680
Lexion 8700		T9.450	TJ380	6490	7715 8690
Lexion 8800		T9.480	TJ425	6495	7715S 8727
Jaguar 930*		T9.505	TJ430	6497	7716 8730
Jaguar 940*		T9.530	TJ450	6499	7716S 8732
Jaguar 950*		T9.530	TJ480	6614	7718 8735
Jaguar 960*		T9.560	TJ500	6615	7718S 8737
Jaguar 970*		T9.565	TJ530	6616	7719 8727S
Jaguar 980*		T9.600		6712	7720 8730S
Jaguar 990*		T9.615		6713	7720S 8732S
		T9.645		6714S	7722 8735S
		T9.670		6715S	7722S 8737S
		T9.700		6716S	7724 8740S

# Introduction

---

The procedures outlined in this guide provide the basic installation procedure for the ESi<sup>2</sup> on the machines specified on the front cover of this guide. If you do not see your machine listed, contact customer support for further instruction. The kit components and corresponding install instructions are designated for each applicable machine make and model and may not be used on undesignated machine models.

## **Review Installation Kit Contents**

Kit contents are outlined in the ESi<sup>2</sup> installation section on pages 10 and 11. Read all applicable installation instructions for your machine's model and ensure that all required kit components are present before beginning the installation.

**NOTE:** Due to manufacturing processes outside of Outback Guidance's control, the installer may have to adapt this kit to your distinct situation.

## **Read and Follow All Safety Messages**

- Refer to the safety manual for the machine that the ESi<sup>2</sup> is being installed on for operating age and precautions.
- Prior to installing and operating the ESi<sup>2</sup>, read and understand all safety precautions as outlined in this guide
- Store this guide and all related safety information with related machine manuals for future reference.

## **Safety Information and Warnings\***

- ESi<sup>2</sup> is NOT designed to replace the machine's operator and is designed as a driving aid for use in precision agriculture applications.
- ESi<sup>2</sup> is NOT intended for use on roadways and should remain disengaged at all times when traveling on roadways.
- ESi<sup>2</sup> does NOT control the speed of the machine and a human operator is required to manually maintain a safe operating speed.
- ESi<sup>2</sup> does NOT avoid obstacles. To prevent human, machine and property injury a human operator is required to operate the machine at all times.
- Do NOT allow anyone to operate without instructions.
- At all times the driver is fully responsible for the safe operation of the vehicle.

\* The safety warnings contained in this installation guide are not meant to be an exhaustive list of potential hazards.



# Introduction

---

- To ensure peak performance, ESi<sup>2</sup> should only be installed after a thorough machine inspection has been conducted. The contents of this kit and ESi<sup>2</sup> are not intended to replace preventative and or needed maintenance. To avoid bodily and machine injury, follow the machine preparation checklist below:
  - ⇒ Inspect steering linkage: Machine should drive in a straight line without manual correction
  - ⇒ Turn off machine and power-off all electronic gauges, monitors and external devices when installing or performing maintenance on the ESi<sup>2</sup>
  - ⇒ Park machine on a clean and level surface
  - ⇒ Lower all implements and headers to the ground
  - ⇒ Apply the parking break and chock wheels
  - ⇒ Inspect any drilling and/or cutting sites to ensure no electrical wiring damage will be incurred

# Install Guide Index

---

This installation guide covers multiple machine types. Refer to the index below to find the section that applies to your machine.

---

## Install #1

### Case IH and New Holland Tractors

For machine specific installation instructions start at page 9.



## Install #2

### Case IH and New Holland Tractors

For machine specific installation instructions start at page 13.



## Install #3

### New Holland Tractors and Case IH Sprayers

For machine specific installation instructions start at page 17.



## Install #4

### Case IH and McCormick MFWD Tractors

For machine specific installation instructions start at page 21.



# Install Guide Index

---

## Install #5

### AGCO MFWD Tractors

For machine specific installation instructions start at page 25.



## Install #6

### AGCO MFWD Tractors

For machine specific installation instructions start at page 29.



## Install #7

### Claas Axion Tractors

For machine specific installation instructions start at page 33.



## Install #8

### Claas Combines and Forage Harvesters

For machine specific installation instructions start at page 37.







# Install #1

## Case IH and New Holland Tractors

---

Remove the steering wheel center cap and the nut holding the steering wheel onto the shaft.

**SAVE** the nut as it will be used later in this installation.

Following the manufacturer's recommended procedure remove the steering wheel.

**NOTE:** Consult your equipment dealer if you are unsure of the correct procedure for removing the steering wheel.



Steering column is ready for ESi<sup>2</sup> installation.



# Install #1

## Case IH and New Holland Tractors

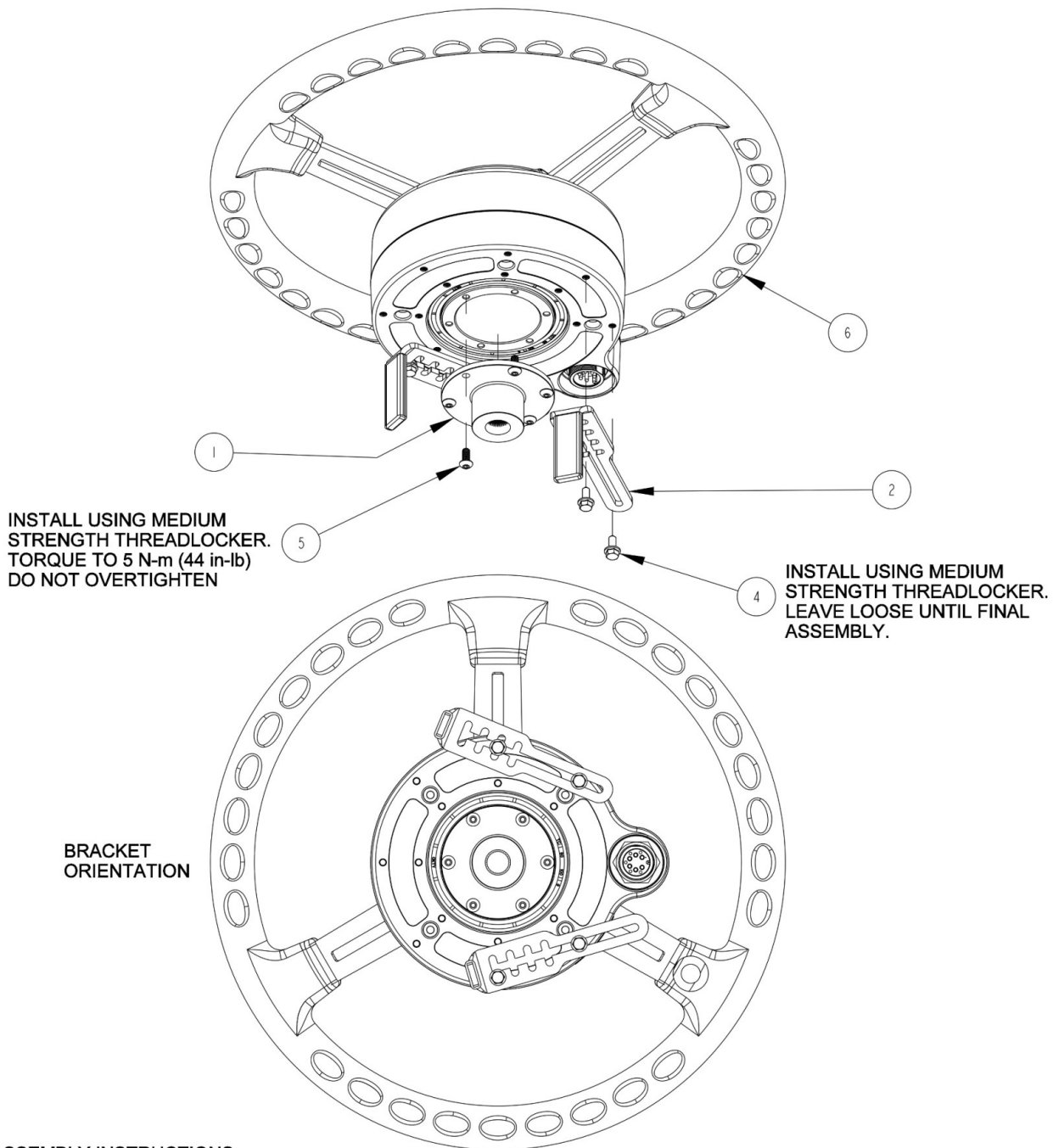

### ASSEMBLY INSTRUCTIONS:

1. PRE-ASSEMBLE SPLINE ADAPTER AND BRACKETS TO WHEEL MOTOR.
2. PLACE ASSEMBLY ON STEERING SHAFT AND RE-INSTALL STEERING SHAFT NUT.
3. ADJUST BRACKETS TO FIT SNUG AGAINST THE STEERING COLUMN.
4. TIGHTEN SCREWS ATTACHING BRACKETS TO BOTTOM OF MOTOR. TORQUE TO 5 N-m (44 in-lb). DO NOT OVERTIGHTEN. ENSURE THAT THE ANTI-ROTATION BRACKETS DO NOT CONTACT THE SPLINE ADAPTER. ENSURE THAT THE MOTOR DOES NOT MOVE IN RELATION TO THE STEERING COLUMN.
5. ROTATE THE WHEEL A FULL TURN TO ENSURE THERE IS NO INTERFERENCE BETWEEN THE BRACKETS AND SPLINE ADAPTER, OR ANY MOVING PARTS AND MACHINE CONTROLS.

# Install #1

## Case IH and New Holland Tractors

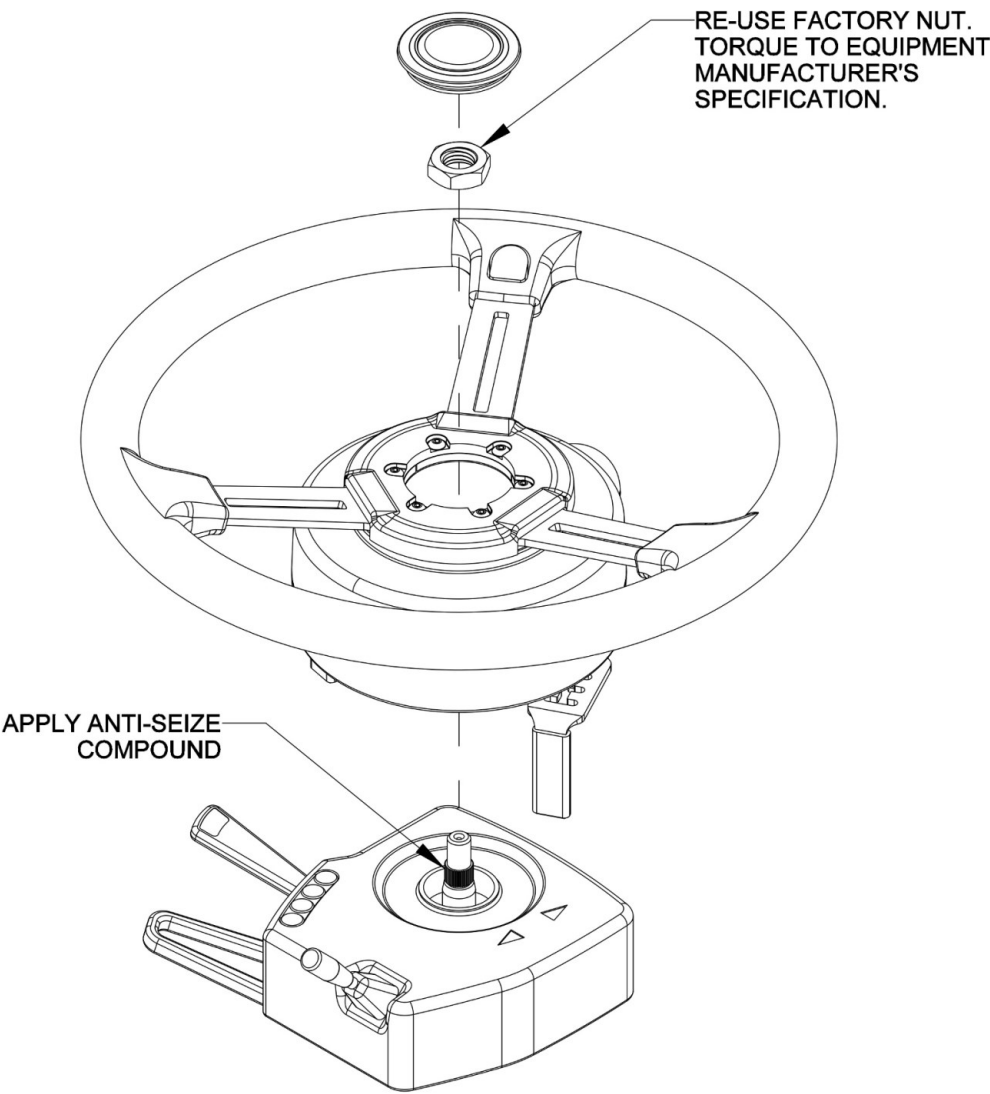

ITEM	QTY	PART NUMBER	DESCRIPTION	NOTES
1	1	604-0071-10	SPLINE ADAPTER- ESI2, 36T x .630 MAJOR x 1.200 OFFSET	
2	2	640-0184-01	ANTI-ROTATION BRACKET	
3	1	675-0126-000	LOCTITE 242 MEDIUM STRENGTH THREADLOCKER	NOT SHOWN
4	4	675-1345-10	SCREW, M5-0.8 X 12MM, HEX FLANGE	
5	6	675-1351-10	SCREW, M5-0.8 X 12MM, BUTTON HEAD	
6	1	910-4024-10	ESI2 ELECTRIC STEERING WHEEL	

# Install #1

## Case IH and New Holland Tractors

---

ESi<sup>2</sup> wheel successfully installed





## Install #2

### Case IH and New Holland Tractors

---

Remove the steering wheel center cap and the nut holding the steering wheel onto the shaft.

**SAVE** the nut as it will be used later in this installation.

Following the manufacturer's recommended procedure remove the steering wheel.

**NOTE:** Consult your equipment dealer if you are unsure of the correct procedure for removing the steering wheel.



Steering column is ready for ESi<sup>2</sup> installation.



# Install #2

## Case IH and New Holland Tractors

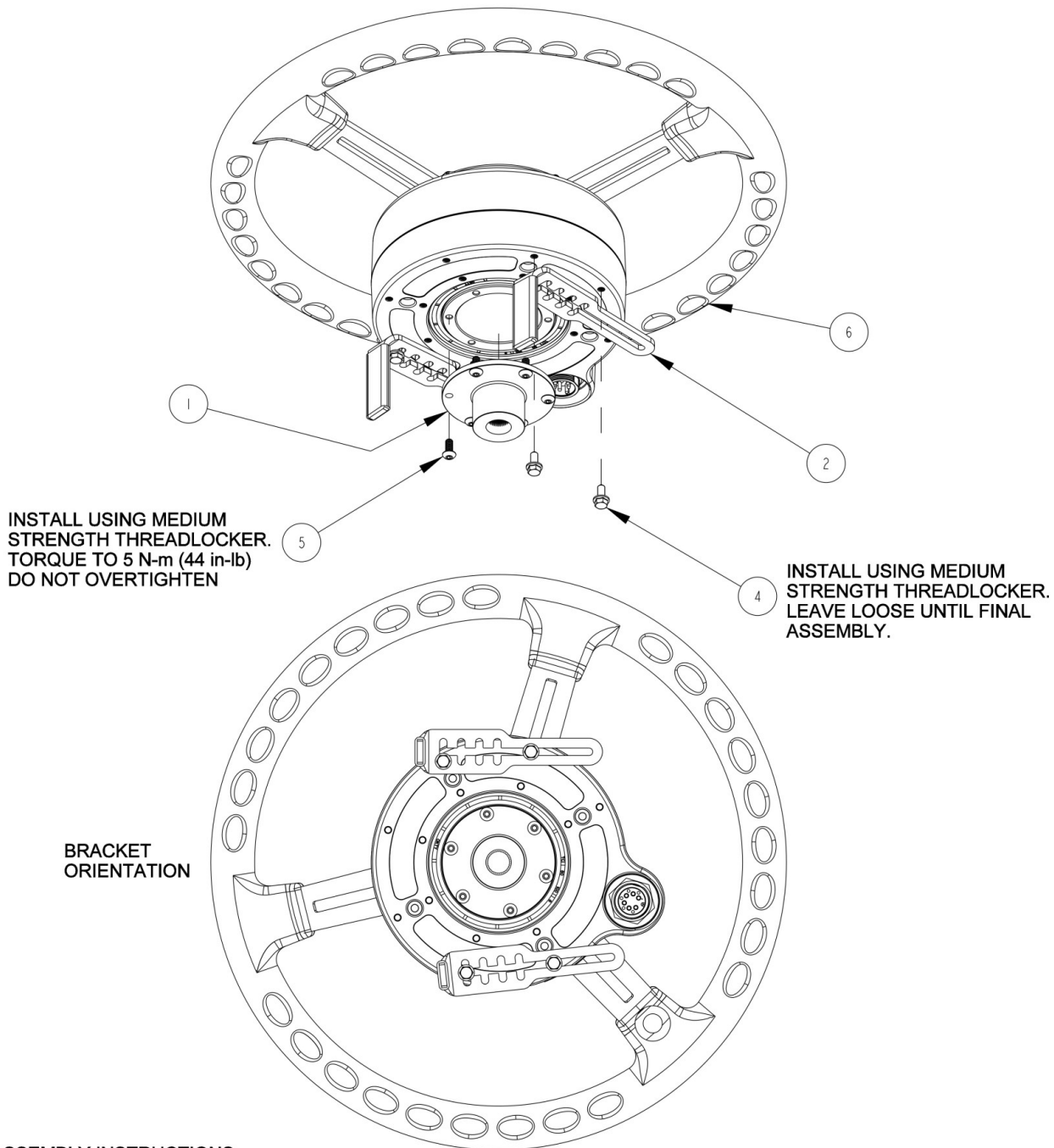

### ASSEMBLY INSTRUCTIONS:

1. PRE-ASSEMBLE SPLINE ADAPTER AND BRACKETS TO WHEEL MOTOR.
2. PLACE ASSEMBLY ON STEERING SHAFT AND RE-INSTALL STEERING SHAFT NUT.
3. ADJUST BRACKETS TO FIT SNUG AGAINST THE STEERING COLUMN.
4. TIGHTEN SCREWS ATTACHING BRACKETS TO BOTTOM OF MOTOR.  
TORQUE TO 5 N-m (44 in-lb). DO NOT OVERTIGHTEN.  
ENSURE THAT THE ANTI-ROTATION BRACKETS DO NOT CONTACT THE SPLINE ADAPTER.  
ENSURE THAT THE MOTOR DOES NOT MOVE IN RELATION TO THE STEERING COLUMN.
5. ROTATE THE WHEEL A FULL TURN TO ENSURE THERE IS NO INTERFERENCE BETWEEN THE BRACKETS AND SPLINE ADAPTER, OR ANY MOVING PARTS AND MACHINE CONTROLS.

# Install #2

## Case IH and New Holland Tractors

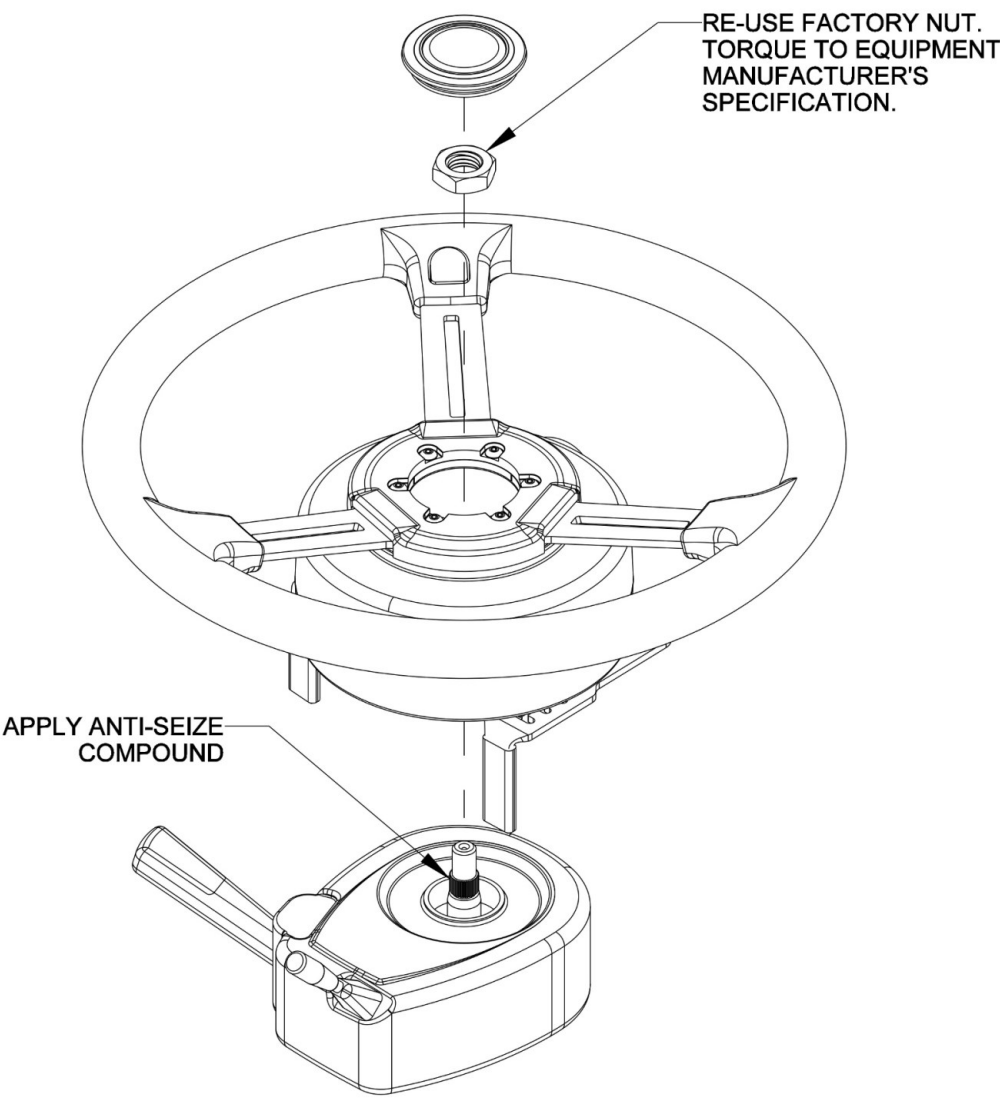

ITEM	QTY	PART NUMBER	DESCRIPTION	NOTES
1	1	604-0071-10	SPLINE ADAPTER- ESi2, 36T x .630 MAJOR x 1.200 OFFSET	
2	2	640-0184-01	ANTI-ROTATION BRACKET	
3	1	675-0126-000	LOCTITE 242 MEDIUM STRENGTH THREADLOCKER	NOT SHOWN
4	4	675-1345-10	SCREW, M5-0.8 X 12MM, HEX FLANGE	
5	6	675-1351-10	SCREW, M5-0.8 X 12MM, BUTTON HEAD	
6	1	910-4024-10	ESi2 ELECTRIC STEERING WHEEL	

## Install #2

### Case IH and New Holland Tractors

---

ESi<sup>2</sup> wheel successfully installed





## Install #3

### New Holland Tractors and Case IH Sprayers

---

Remove the steering wheel center cap and the nut holding the steering wheel onto the shaft.

**SAVE** the nut as it will be used later in this installation.

Following the manufacturer's recommended procedure remove the steering wheel.

**NOTE:** Consult your equipment dealer if you are unsure of the correct procedure for removing the steering wheel.



Steering column is ready for ESi<sup>2</sup> installation.



# Install #3

## New Holland Tractors and Case IH Sprayers

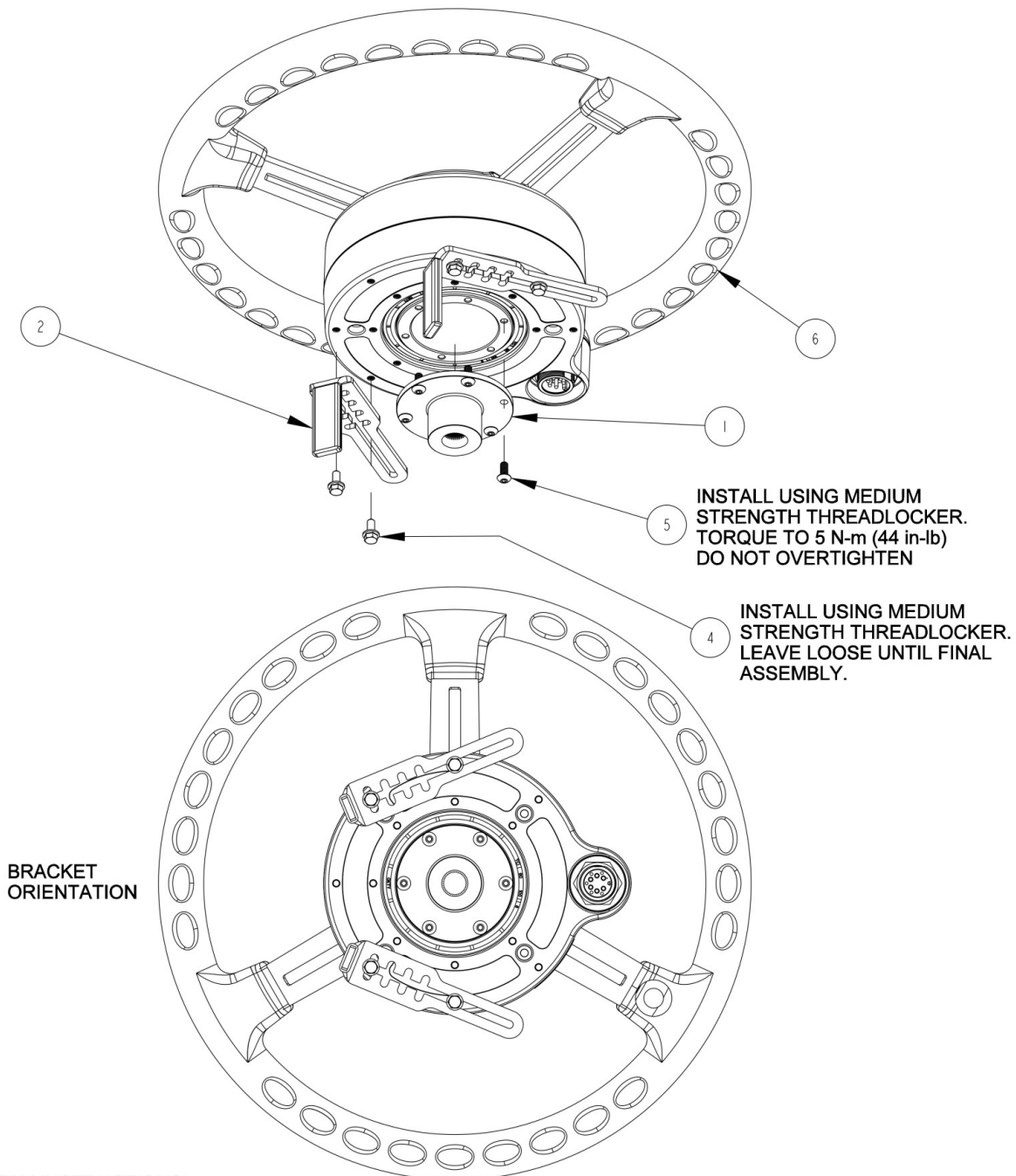

### ASSEMBLY INSTRUCTIONS:

1. PRE-ASSEMBLE SPLINE ADAPTER AND BRACKETS TO WHEEL MOTOR.
2. PLACE ASSEMBLY ON STEERING SHAFT AND RE-INSTALL STEERING SHAFT NUT.
3. ADJUST BRACKETS TO FIT SNUG AGAINST THE STEERING COLUMN.
4. TIGHTEN SCREWS ATTACHING BRACKETS TO BOTTOM OF MOTOR. TORQUE TO 5 N-m (44 in-lb). DO NOT OVERTIGHTEN. ENSURE THAT THE ANTI-ROTATION BRACKETS DO NOT CONTACT THE SPLINE ADAPTER. ENSURE THAT THE MOTOR DOES NOT MOVE IN RELATION TO THE STEERING COLUMN.
5. ROTATE THE WHEEL A FULL TURN TO ENSURE THERE IS NO INTERFERENCE BETWEEN THE BRACKETS AND SPLINE ADAPTER, OR ANY MOVING PARTS AND MACHINE CONTROLS.

# Install #3

New Holland Tractors and Case IH Sprayers

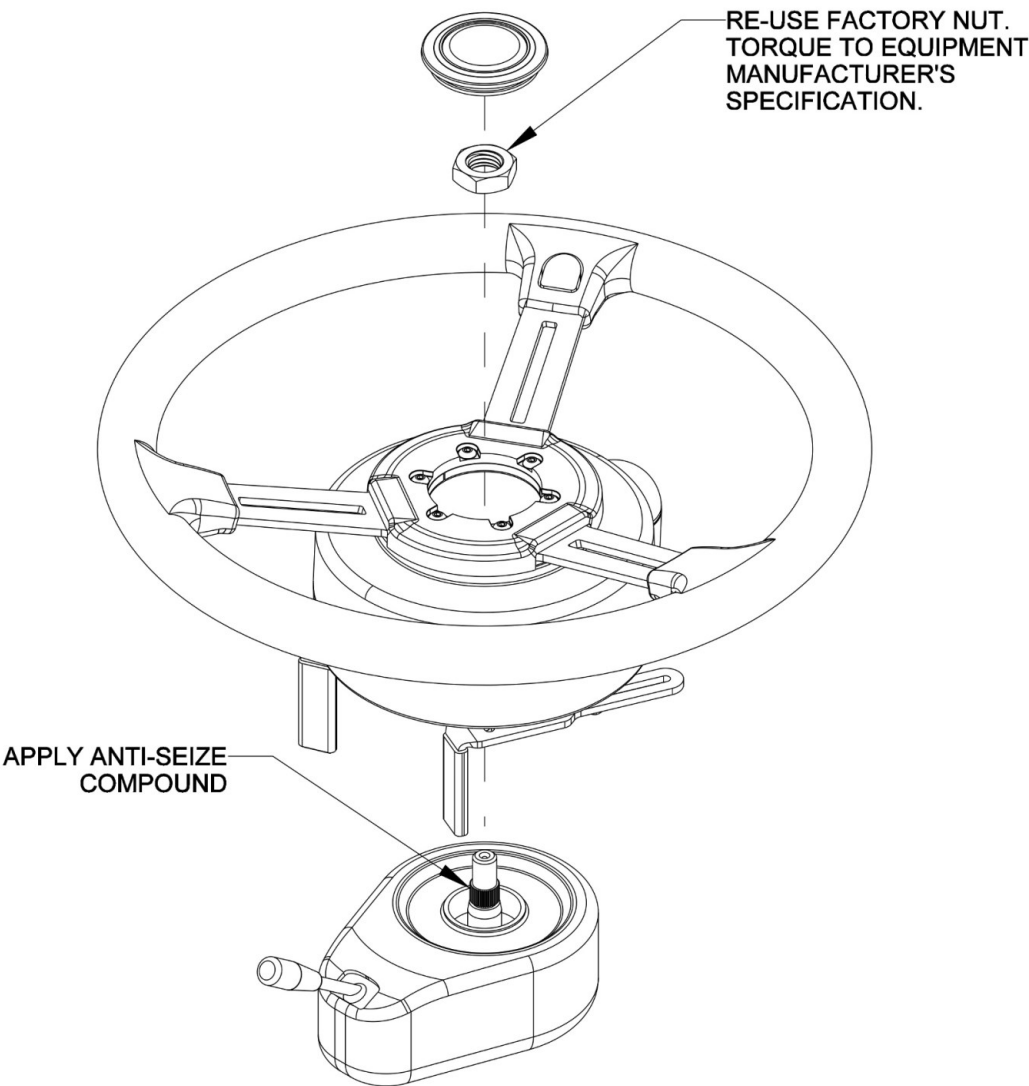

ITEM	QTY	PART NUMBER	DESCRIPTION	NOTES
1	1	604-0071-10	SPLINE ADAPTER- ESI2, 36T x .630 MAJOR x 1.200 OFFSET	
2	2	640-0184-01	ANTI-ROTATION BRACKET	
3	1	675-0126-000	LOCTITE 242 MEDIUM STRENGTH THREADLOCKER	NOT SHOWN
4	4	675-1345-10	SCREW, M5-0.8 X 12MM, HEX FLANGE	
5	6	675-1351-10	SCREW, M5-0.8 X 12MM, BUTTON HEAD	
6	1	910-4024-10	ESI2 ELECTRIC STEERING WHEEL	

# Install #3

## New Holland Tractors and Case IH Sprayers

---

ESi<sup>2</sup> wheel successfully installed





# Install #4

## Case IH and McCormick MFWD Tractors

---

Remove the steering wheel center cap and the nut holding the steering wheel onto the shaft.

**SAVE** the nut as it will be used later in this installation.

Following the manufacturer's recommended procedure remove the steering wheel.

***NOTE: Consult your equipment dealer if you are unsure of the correct procedure for removing the steering wheel.***



Steering column is ready for ESi<sup>2</sup> installation.



# Install #4

## Case IH and McCormick MFWD Tractors

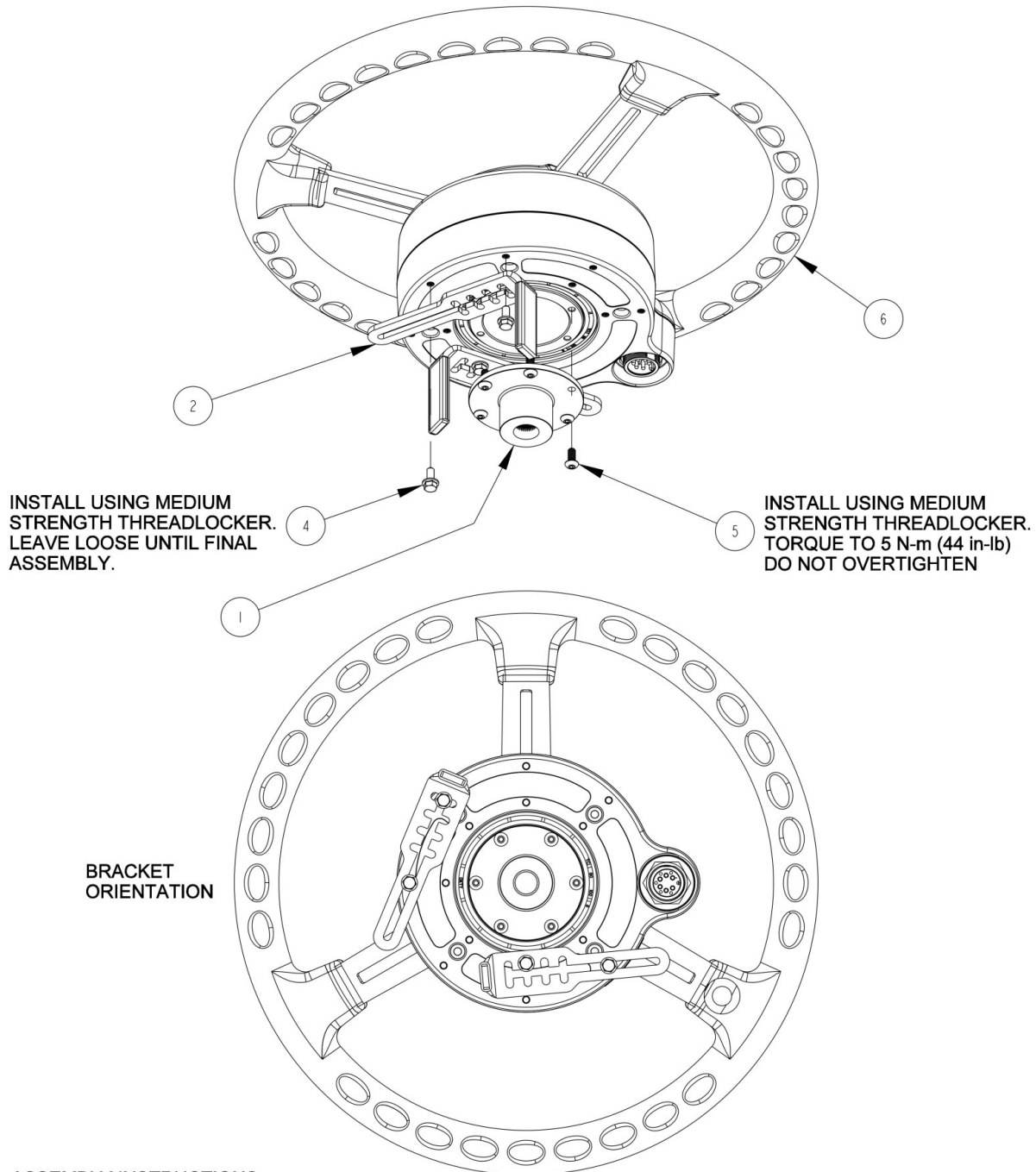

### ASSEMBLY INSTRUCTIONS:

1. PRE-ASSEMBLE SPLINE ADAPTER AND BRACKETS TO WHEEL MOTOR.
2. PLACE ASSEMBLY ON STEERING SHAFT AND RE-INSTALL STEERING SHAFT NUT.
3. ADJUST BRACKETS TO FIT SNUG AGAINST THE STEERING COLUMN.
4. TIGHTEN SCREWS ATTACHING BRACKETS TO BOTTOM OF MOTOR. TORQUE TO 5 N-m (44 in-lb). DO NOT OVERTIGHTEN. ENSURE THAT THE ANTI-ROTATION BRACKETS DO NOT CONTACT THE SPLINE ADAPTER. ENSURE THAT THE MOTOR DOES NOT MOVE IN RELATION TO THE STEERING COLUMN.
5. ROTATE THE WHEEL A FULL TURN TO ENSURE THERE IS NO INTERFERENCE BETWEEN THE BRACKETS AND SPLINE ADAPTER, OR ANY MOVING PARTS AND MACHINE CONTROLS.

# Install #4

## Case IH and McCormick MFWD Tractors

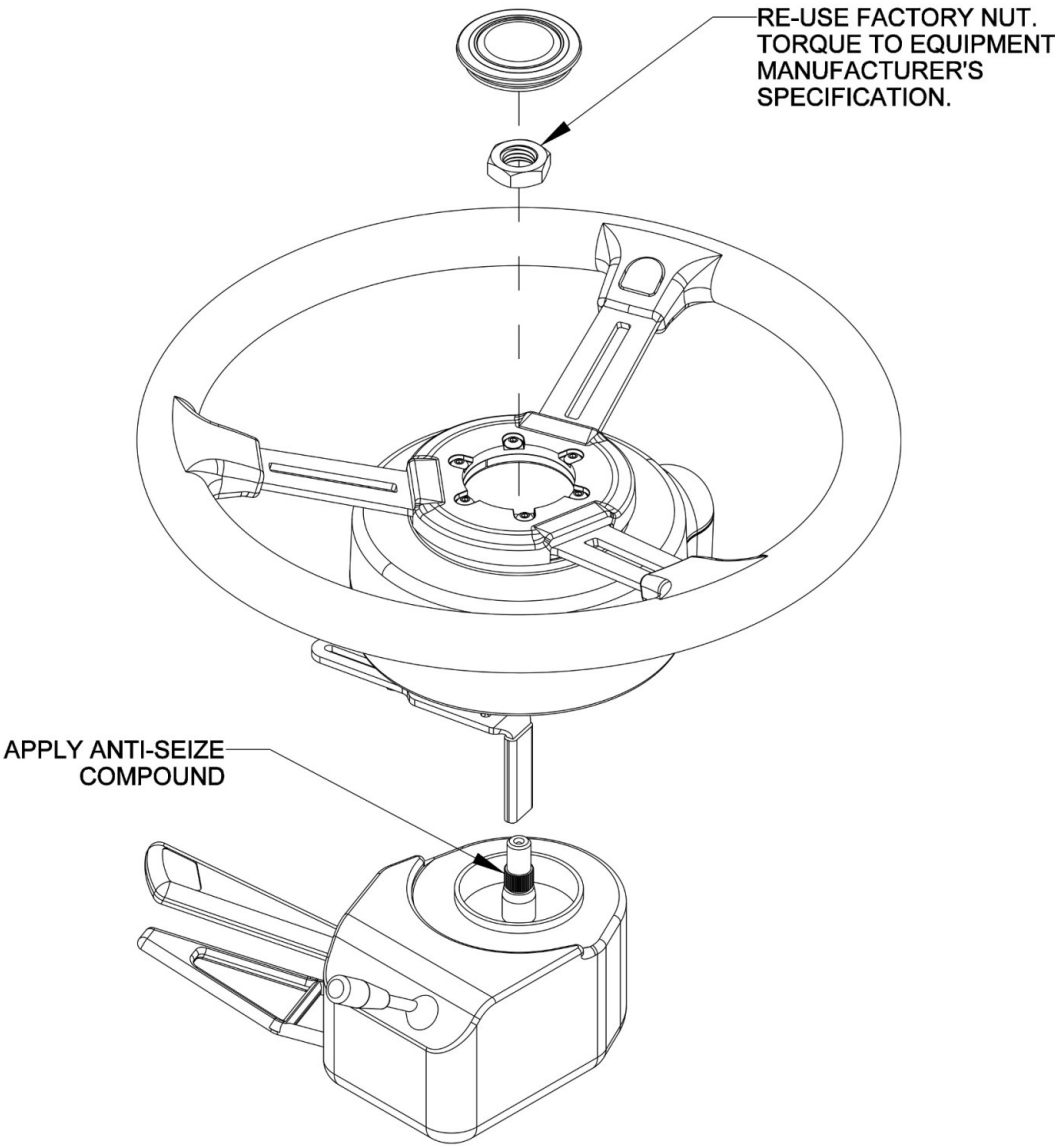

ITEM	QTY	PART NUMBER	DESCRIPTION	NOTES
1	1	604-0071-10	SPLINE ADAPTER- ES12, 36T x .630 MAJOR x 1.200 OFFSET	
2	2	640-0184-01	ANTI-ROTATION BRACKET	
3	1	675-0126-000	LOCTITE 242 MEDIUM STRENGTH THREADLOCKER	NOT SHOWN
4	4	675-1345-10	SCREW, M5-0.8 X 12MM, HEX FLANGE	
5	6	675-1351-10	SCREW, M5-0.8 X 12MM, BUTTON HEAD	
6	1	910-4024-10	ES12 ELECTRIC STEERING WHEEL	

# Install #4

## Case IH and McCormick MFWD Tractors

---

ESi<sup>2</sup> wheel successfully installed





# Install #5

## AGCO MFWD Tractors

---

Remove the steering wheel center cap and the nut holding the steering wheel onto the shaft.

**SAVE** the nut as it will be used later in this installation.

Following the manufacturer's recommended procedure remove the steering wheel.

***NOTE: Consult your equipment dealer if you are unsure of the correct procedure for removing the steering wheel.***



Steering column is ready for ESi<sup>2</sup> installation.



# Install #5

## AGCO MFWD Tractors

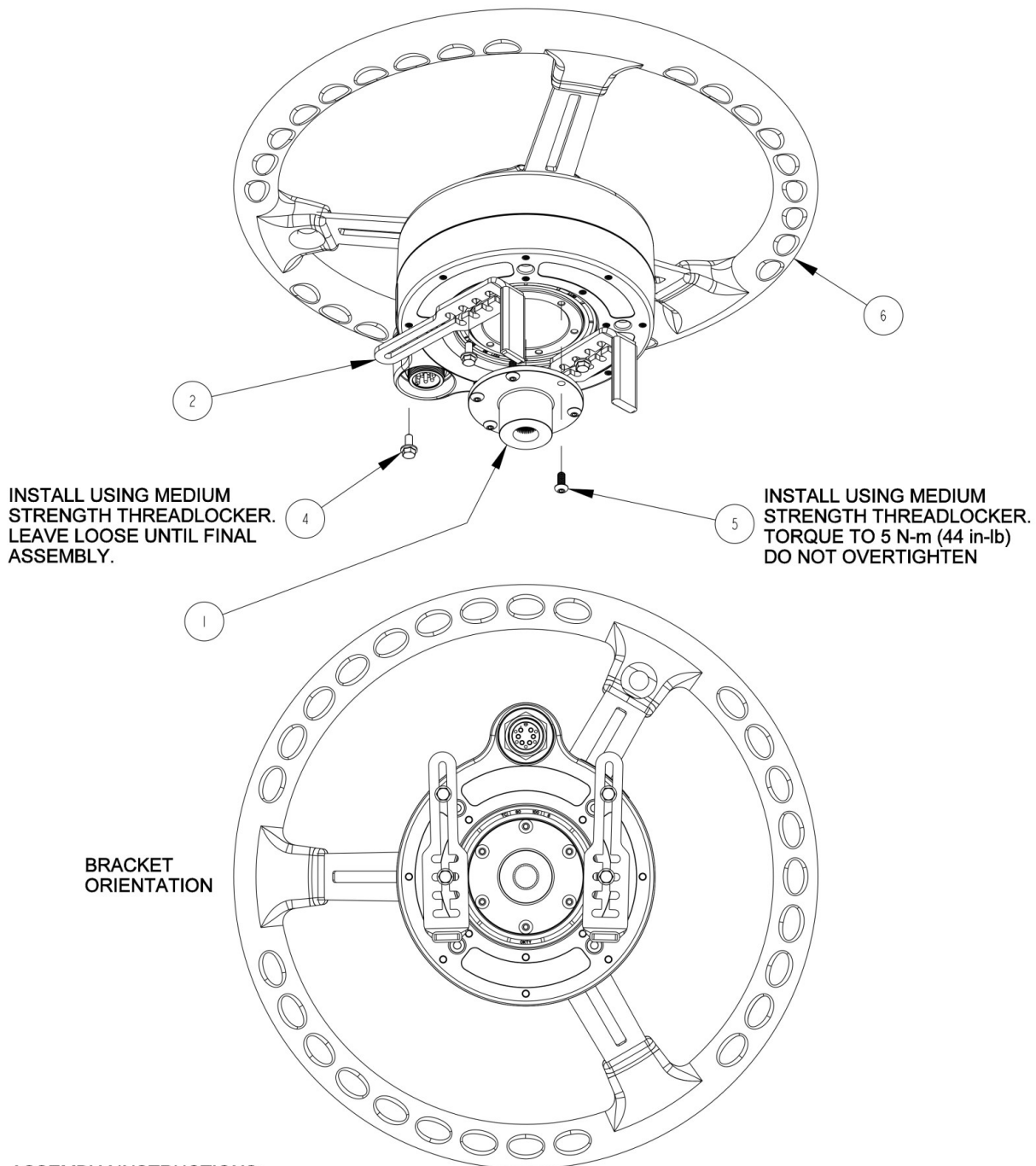

### ASSEMBLY INSTRUCTIONS:

1. PRE-ASSEMBLE SPLINE ADAPTER AND BRACKETS TO WHEEL MOTOR.
2. PLACE ASSEMBLY ON STEERING SHAFT AND RE-INSTALL STEERING SHAFT NUT.
3. ADJUST BRACKETS TO FIT SNUG AGAINST THE STEERING COLUMN.
4. TIGHTEN SCREWS ATTACHING BRACKETS TO BOTTOM OF MOTOR.  
TORQUE TO 5 N-m (44 in-lb). DO NOT OVERTIGHTEN.  
ENSURE THAT THE ANTI-ROTATION BRACKETS DO NOT CONTACT THE SPLINE ADAPTER.  
ENSURE THAT THE MOTOR DOES NOT MOVE IN RELATION TO THE STEERING COLUMN.
5. ROTATE THE WHEEL A FULL TURN TO ENSURE THERE IS NO INTERFERENCE BETWEEN THE BRACKETS AND SPLINE ADAPTER, OR ANY MOVING PARTS AND MACHINE CONTROLS.

# Install #5

## AGCO MFWD Tractors

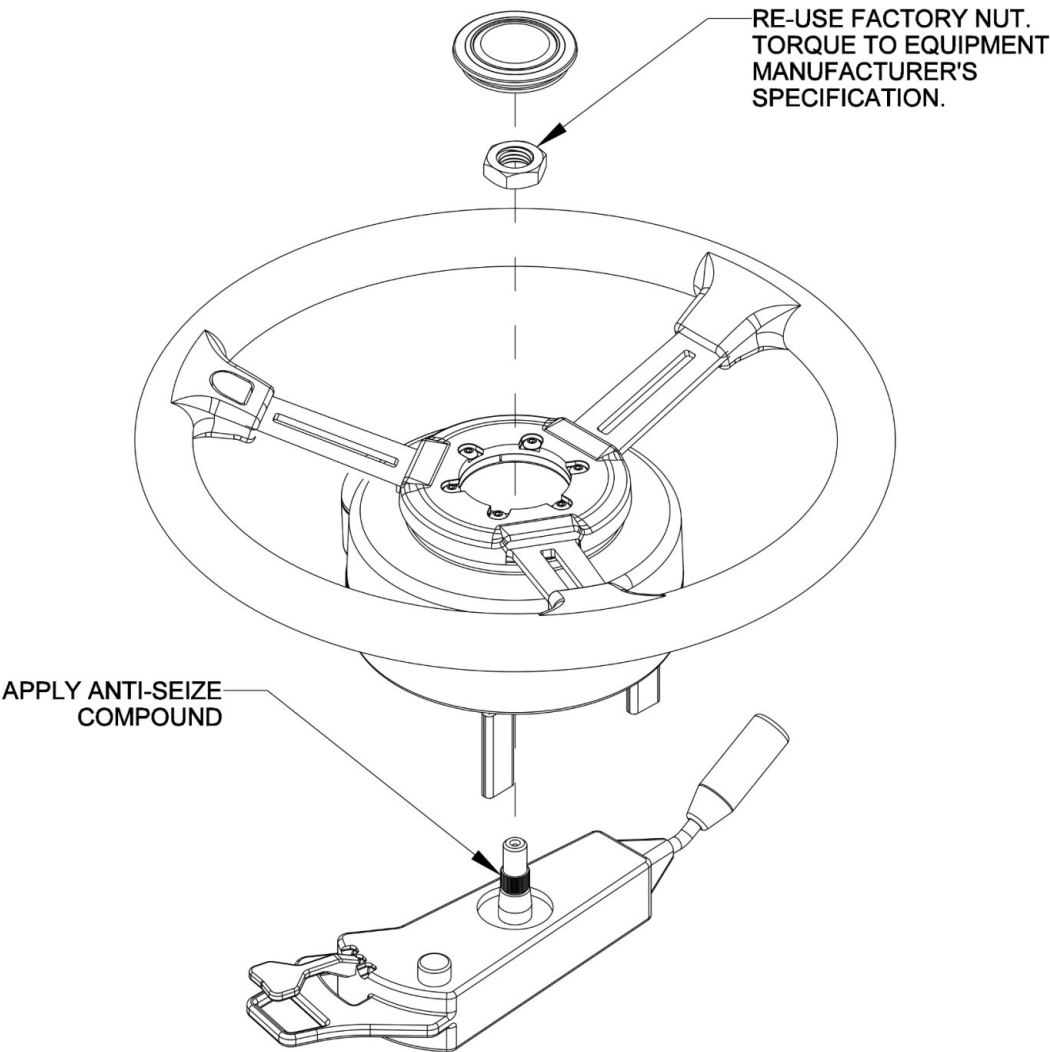

ITEM	QTY	PART NUMBER	DESCRIPTION	NOTES
1	1	604-0071-10	SPLINE ADAPTER- ESI2, 36T x .630 MAJOR x 1.200 OFFSET	
2	2	640-0184-01	ANTI-ROTATION BRACKET	
3	1	675-0126-000	LOCTITE 242 MEDIUM STRENGTH THREADLOCKER	NOT SHOWN
4	4	675-1345-10	SCREW, M5-0.8 X 12MM, HEX FLANGE	
5	6	675-1351-10	SCREW, M5-0.8 X 12MM, BUTTON HEAD	
6	1	910-4024-10	ESI2 ELECTRIC STEERING WHEEL	

# Install #5

## AGCO MFWD Tractors

---

ESi<sup>2</sup> wheel successfully installed





# Install #6

## AGCO MFWD Tractors

---

Remove the steering wheel center cap and the nut holding the steering wheel onto the shaft.

**SAVE** the nut as it will be used later in this installation.

Following the manufacturer's recommended procedure remove the steering wheel.

***NOTE: Consult your equipment dealer if you are unsure of the correct procedure for removing the steering wheel.***



Steering column is ready for ESi<sup>2</sup> installation.



# Install #6

## AGCO MFWD Tractors

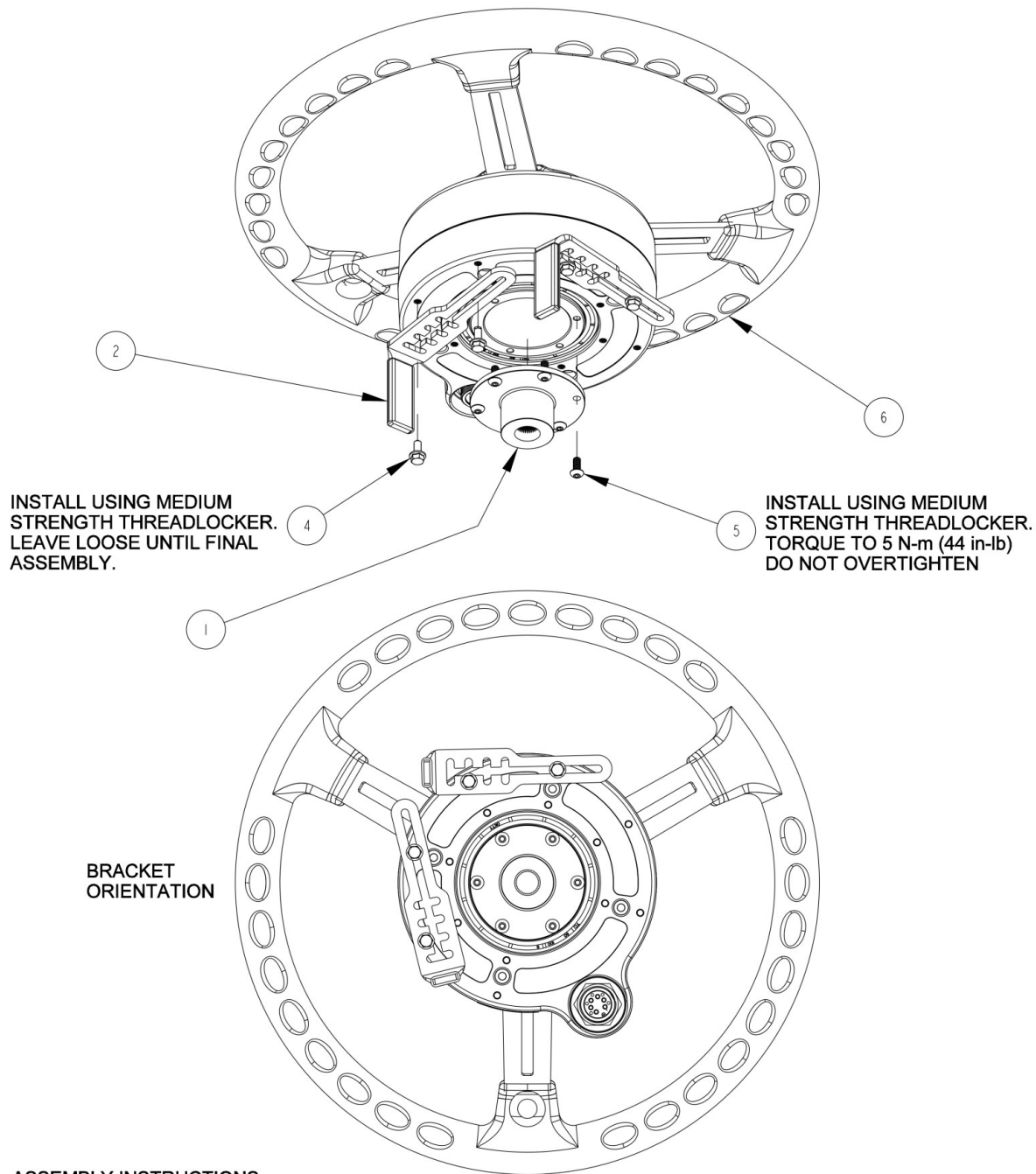

### ASSEMBLY INSTRUCTIONS:

1. PRE-ASSEMBLE SPLINE ADAPTER AND BRACKETS TO WHEEL MOTOR.
2. PLACE ASSEMBLY ON STEERING SHAFT AND RE-INSTALL STEERING SHAFT NUT.
3. ADJUST BRACKETS TO FIT SNUG AGAINST THE STEERING COLUMN.
4. TIGHTEN SCREWS ATTACHING BRACKETS TO BOTTOM OF MOTOR.  
TORQUE TO 5 N-m (44 in-lb). DO NOT OVERTIGHTEN.  
ENSURE THAT THE ANTI-ROTATION BRACKETS DO NOT CONTACT THE SPLINE ADAPTER.  
ENSURE THAT THE MOTOR DOES NOT MOVE IN RELATION TO THE STEERING COLUMN.
5. ROTATE THE WHEEL A FULL TURN TO ENSURE THERE IS NO INTERFERENCE BETWEEN THE BRACKETS AND SPLINE ADAPTER, OR ANY MOVING PARTS AND MACHINE CONTROLS.

# Install #6

## AGCO MFWD Tractors

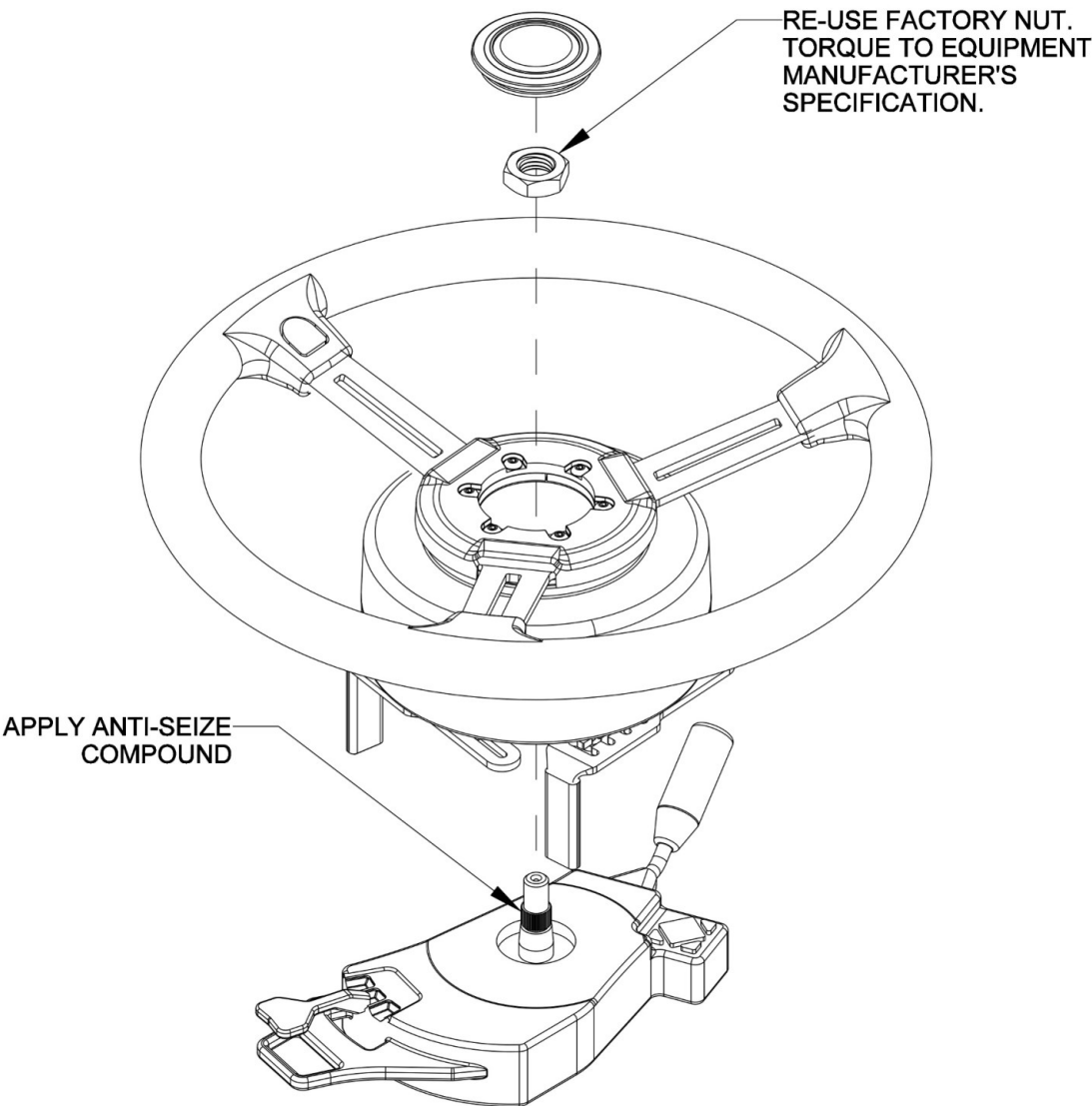

ITEM	QTY	PART NUMBER	DESCRIPTION	NOTES
1	1	604-0071-10	SPLINE ADAPTER- ESI2, 36T x .630 MAJOR x 1.200 OFFSET	
2	2	640-0184-01	ANTI-ROTATION BRACKET	
3	1	675-0126-000	LOCTITE 242 MEDIUM STRENGTH THREADLOCKER	NOT SHOWN
4	4	675-1345-10	SCREW, M5-0.8 X 12MM, HEX FLANGE	
5	6	675-1351-10	SCREW, M5-0.8 X 12MM, BUTTON HEAD	
6	1	910-4024-10	ESI2 ELECTRIC STEERING WHEEL	

# Install #6

## AGCO MFWD Tractors

---

ESi<sup>2</sup> wheel successfully installed





# Install #7

## Claas Axion Tractors

---

Remove the steering wheel center cap and the nut holding the steering wheel onto the shaft.

**SAVE** the nut as it will be used later in this installation.

Following the manufacturer's recommended procedure remove the steering wheel.

**NOTE: Consult your equipment dealer if you are unsure of the correct procedure for removing the steering wheel.**



Steering column is ready for ESi<sup>2</sup> installation.



# Install #7

## Claas Axion Tractors

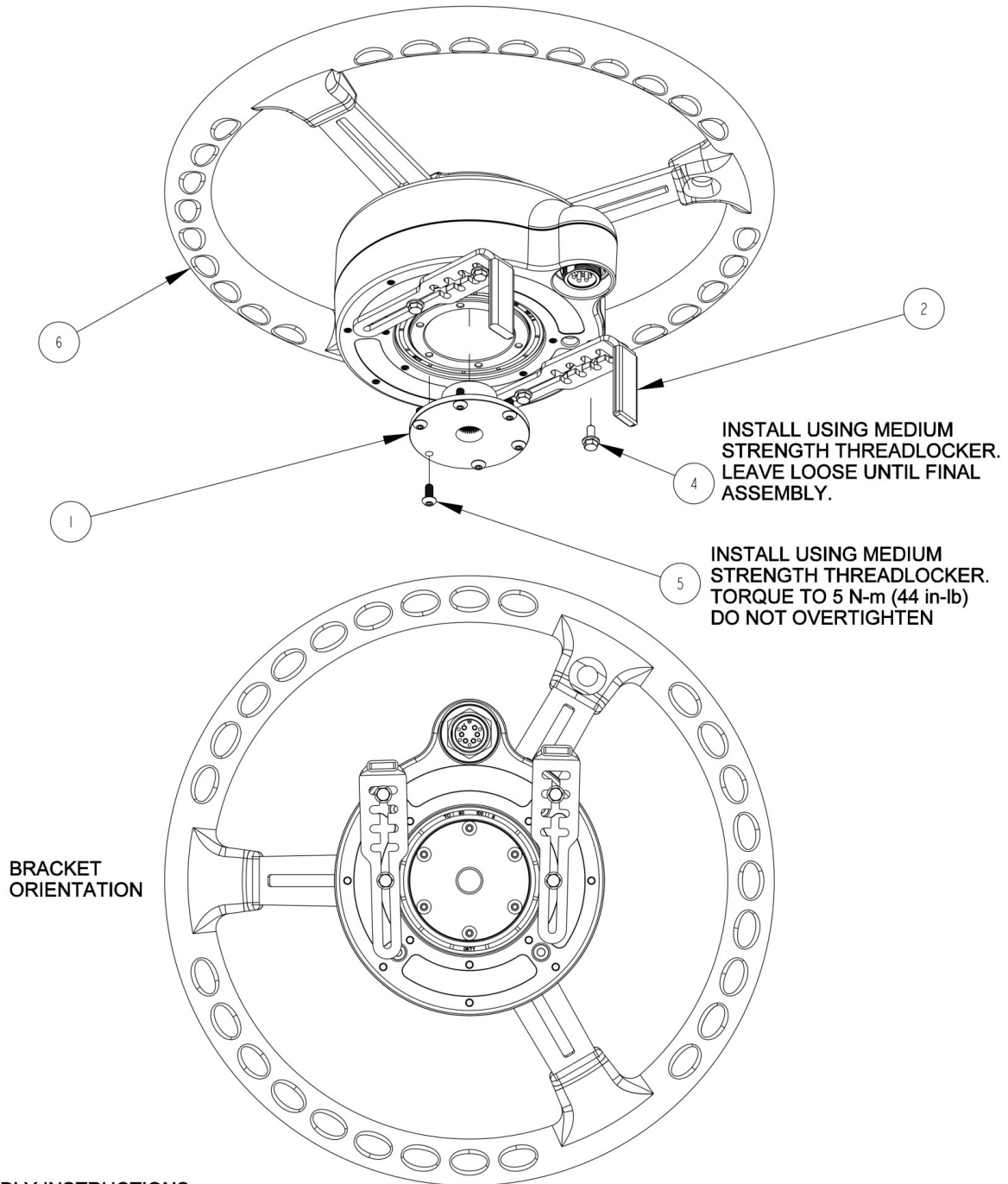

### ASSEMBLY INSTRUCTIONS:

1. PRE-ASSEMBLE SPLINE ADAPTER AND BRACKETS TO WHEEL MOTOR.
2. PLACE ASSEMBLY ON STEERING SHAFT AND RE-INSTALL STEERING SHAFT NUT.
3. ADJUST BRACKETS TO FIT SNUG AGAINST THE STEERING COLUMN.
4. TIGHTEN SCREWS ATTACHING BRACKETS TO BOTTOM OF MOTOR.  
TORQUE TO 5 N-m (44 in-lb). DO NOT OVERTIGHTEN.  
ENSURE THAT THE ANTI-ROTATION BRACKETS DO NOT CONTACT THE SPLINE ADAPTER.  
ENSURE THAT THE MOTOR DOES NOT MOVE IN RELATION TO THE STEERING COLUMN.
5. ROTATE THE WHEEL A FULL TURN TO ENSURE THERE IS NO INTERFERENCE BETWEEN THE BRACKETS AND SPLINE ADAPTER, OR ANY MOVING PARTS AND MACHINE CONTROLS.

# Install #7

## Claas Axion Tractors

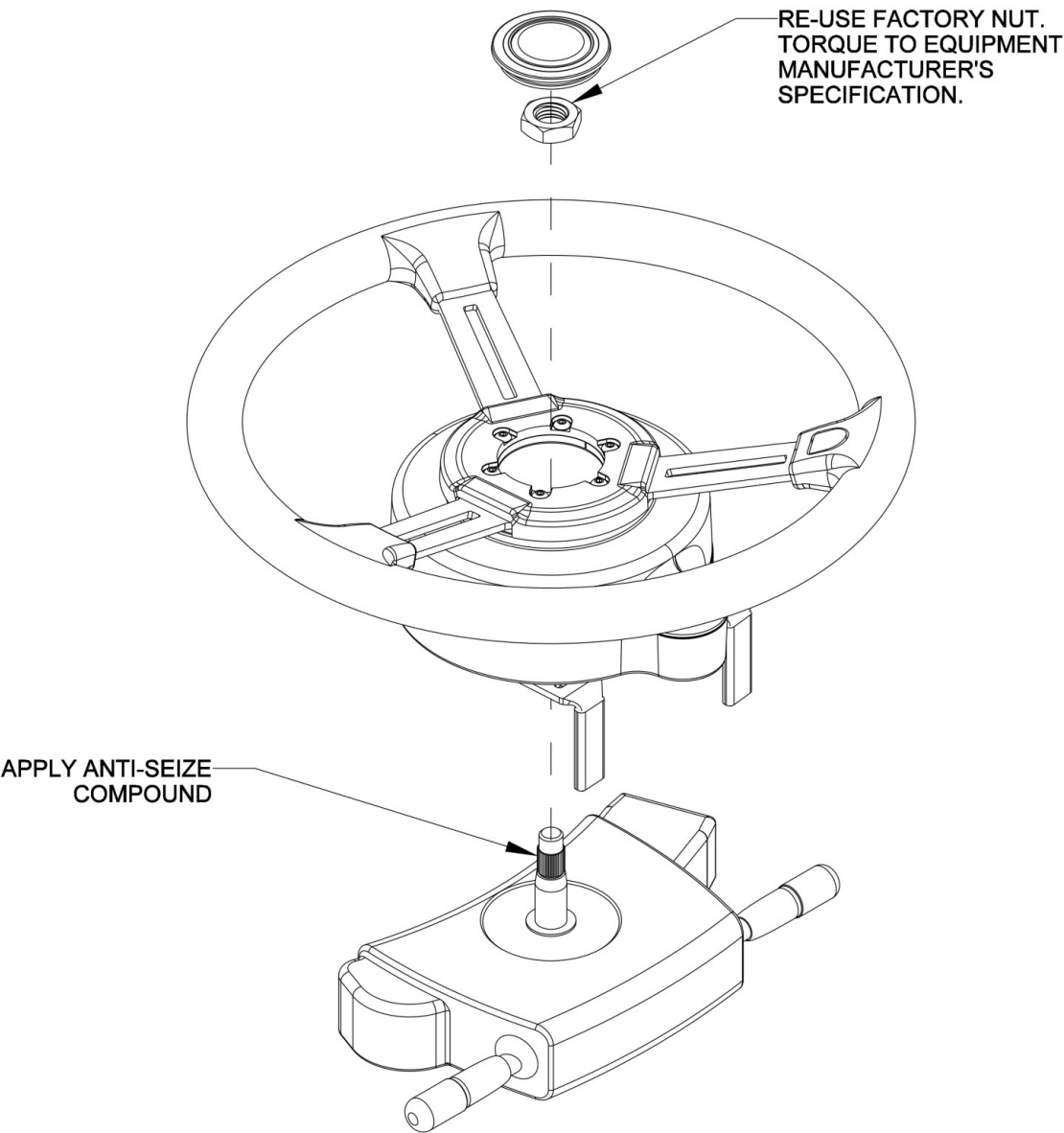

ITEM	QTY	PART NUMBER	DESCRIPTION	NOTES
1	1	604-0071-10	SPLINE ADAPTER- ESI2, 36T x .630 MAJOR x 1.200 OFFSET	
2	2	640-0184-01	ANTI-ROTATION BRACKET	
3	1	675-0126-000	LOCTITE 242 MEDIUM STRENGTH THREADLOCKER	NOT SHOWN
4	4	675-1345-10	SCREW, M5-0.8 X 12MM, HEX FLANGE	
5	6	675-1351-10	SCREW, M5-0.8 X 12MM, BUTTON HEAD	
6	1	910-4024-10	ESI2 ELECTRIC STEERING WHEEL	

# Install #7

## Claas Axion Tractors

---

ESi<sup>2</sup> wheel successfully installed





# Install #8

## Claas Combines and Forage Harvesters

---

Remove the steering wheel center cap and the nut holding the steering wheel onto the shaft.

**SAVE** the nut as it will be used later in this installation.

Following the manufacturer's recommended procedure remove the steering wheel.

***NOTE: Consult your equipment dealer if you are unsure of the correct procedure for removing the steering wheel.***

Steering column is ready for ESi<sup>2</sup> installation.



# Install #8

## Claas Combines and Forage Harvesters

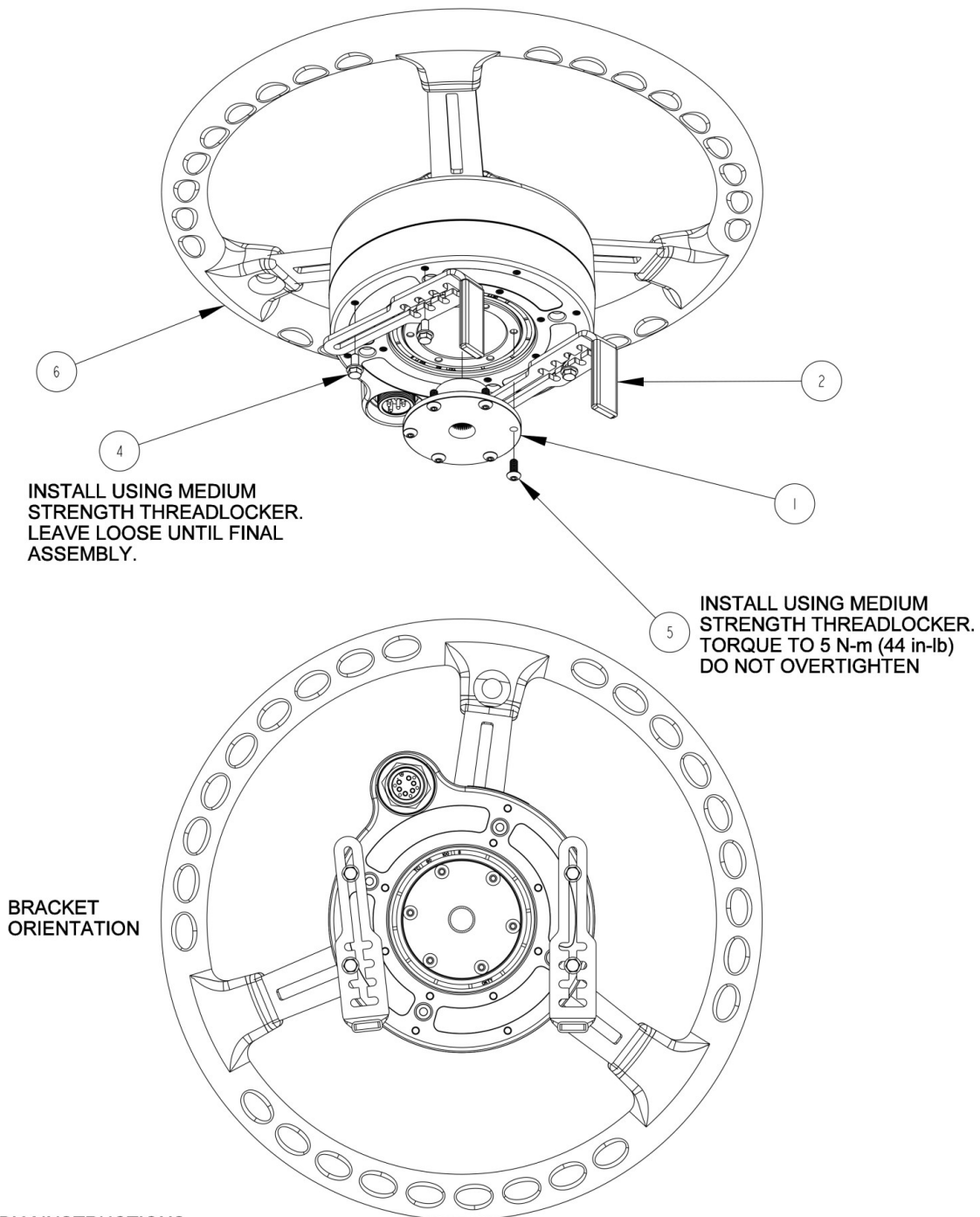

### ASSEMBLY INSTRUCTIONS:

1. PRE-ASSEMBLE SPLINE ADAPTER AND BRACKETS TO WHEEL MOTOR.
2. PLACE ASSEMBLY ON STEERING SHAFT AND RE-INSTALL STEERING SHAFT NUT.
3. ADJUST BRACKETS TO FIT SNUG AGAINST THE STEERING COLUMN.
4. TIGHTEN SCREWS ATTACHING BRACKETS TO BOTTOM OF MOTOR.  
TORQUE TO 5 N-m (44 in-lb). DO NOT OVERTIGHTEN.  
ENSURE THAT THE ANTI-ROTATION BRACKETS DO NOT CONTACT THE SPLINE ADAPTER.  
ENSURE THAT THE MOTOR DOES NOT MOVE IN RELATION TO THE STEERING COLUMN.
5. ROTATE THE WHEEL A FULL TURN TO ENSURE THERE IS NO INTERFERENCE BETWEEN THE BRACKETS AND SPLINE ADAPTER, OR ANY MOVING PARTS AND MACHINE CONTROLS.

# Install #8

## Claas Combines and Forage Harvesters

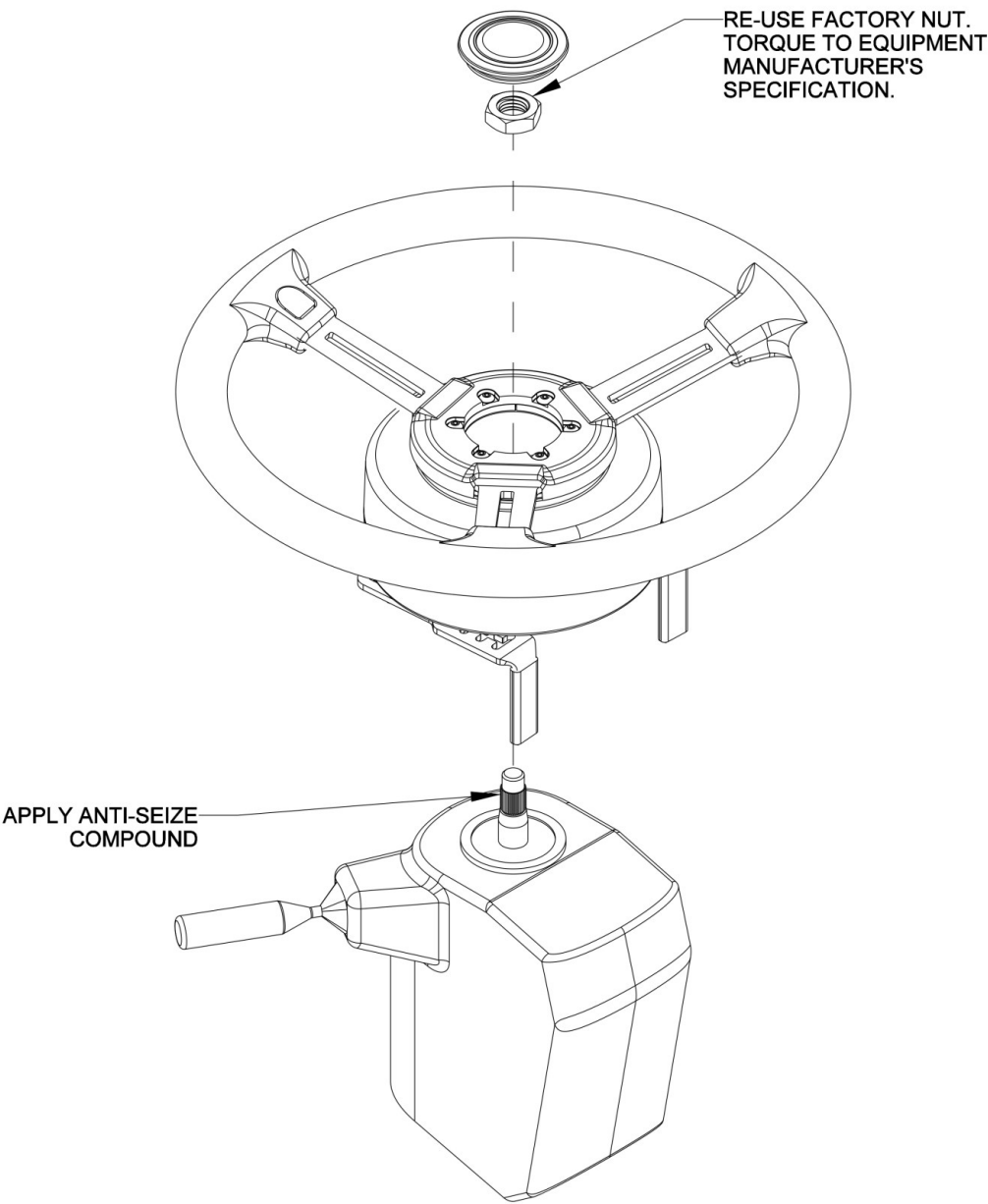

ITEM	QTY	PART NUMBER	DESCRIPTION	NOTES
1	1	604-0071-10	SPLINE ADAPTER- ESI2, 36T x .630 MAJOR x 1.200 OFFSET	
2	2	640-0184-01	ANTI-ROTATION BRACKET	
3	1	675-0126-000	LOCTITE 242 MEDIUM STRENGTH THREADLOCKER	NOT SHOWN
4	4	675-1345-10	SCREW, M5-0.8 X 12MM, HEX FLANGE	
5	6	675-1351-10	SCREW, M5-0.8 X 12MM, BUTTON HEAD	
6	1	910-4024-10	ESI2 ELECTRIC STEERING WHEEL	

# Install #8

## Claas Combines and Forage Harvesters

---

ESi<sup>2</sup> wheel successfully installed

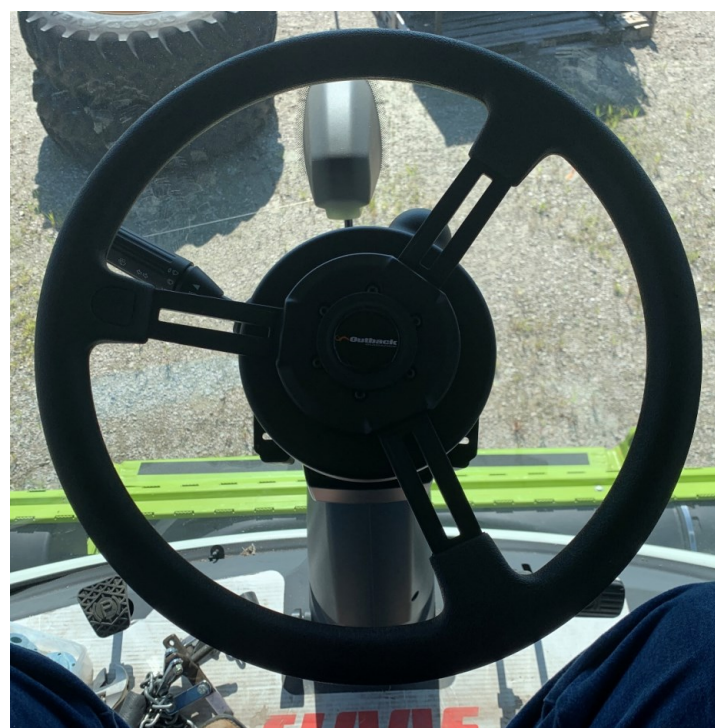

## Install Completion Checklist

---

- Ensure steering wheel turns freely and anti-rotation brackets do not contact the spline adapter.
- Check, and if needed, tighten anti-rotation brackets to eliminate excess movement. Loose anti-rotation brackets can cause poor steering performance.
- For steering ECU installation instructions please refer to the ECU installation guide that came with your installation kit.